

ESSENCE HOMES

EL DORADO

E S T A T E S

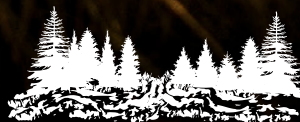



INTRODUCING EL DORADO ESTATES

The Introduction

THE
GOLDEN
GLADE

In a hidden opening in the forest of Eldorado Park, along a quiet cul-de-sac set against Credit River, is a private community of just thirty-five homes. A place built on exclusivity, safety and stillness, but also exploration, connection and togetherness. With the charms of old days and the designs of new, yesterday and tomorrow meet, in the timeless space of today.

This is an entirely new way of live Brampton. And only a few will be able to. It's an opportunity to be at the centre of the city's most definitive experiences. To walk through lush landscapes one moment and urban energy the next. To surround yourself with golf courses, parks, creeks and trails, with community centres, boutique retailers and gourmet trendsetters. To be at home in both environments, the natural and the one we built.

Speak now about sunrises and sunsets, fairways and four seasons. Here, in the opening hidden in the forest, in the golden glade, is El Dorado Estates.

THIRTY-FIVE SINGLE FAMILY RESIDENCES

The Luxury of Cul-de-Sac Living

El Dorado Estates was designed seamlessly with its surroundings, created with deliberate intent. Just one road leads to this cul-de-sac community and returns to residents a lifestyle found increasingly less in today's urban cities. One that lets you own the outdoors. The experience is safer, more private, and with less drive-through traffic on the street, families have their freedom; children can play, explore and grow; neighbours connect, and the community takes on a life of its own.

Each home in the very limited collection is a vision of modern architecture and interior design. Form and function were carefully considered, how the finest details would interact with the grand design, the material, its texture and tone. Together, the residences are in close conversation with nature, a dialogue that maximizes space, sunlight and views. With such an emphasis on detail, on curated design and exclusivity, it feels everything like a gated community. But instead of high walls, El Dorado Estates has acres and canopies of trees.

There is and always will be a higher demand for these lots, that lifestyle, this life. It's the original luxury, and it is for generations.

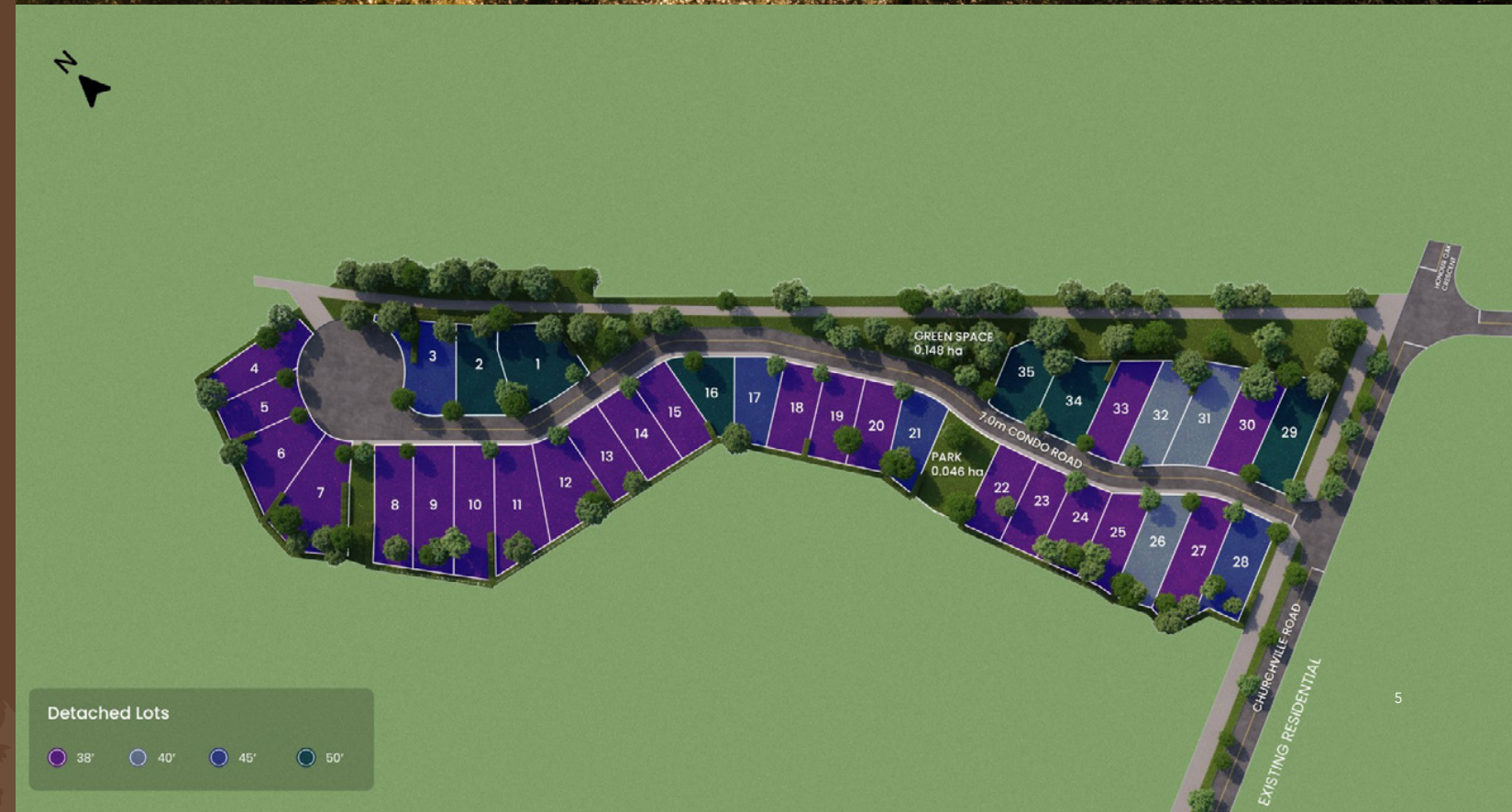



EL DORADO



The Promise

CREDITVIEW RD.

“ When we envisioned El Dorado Estates, we knew it was more than a community. We saw a retreat, private and precious, that brought families together away from the summons of the big city. To realize the vision, we had to achieve the new. It was an exercise in introspection, to intentionally create the limited, to demonstrate restraint and leave open spaces. This is what allowed us our enviable location—and we spared no expense or resource to make the most of it. The richness of the landscape is reflected in each residence, which we built as if for ourselves.

That is our promise.

That we each of us would live in the residences we build. Our pride? That we made them for you. You, who can take El Dorado further than even we imagined, and call it home.”





The Site

A NATURAL ADVANTAGE

So Close and Still So Quiet

GO, Züm, thoroughfares, highways: the streets around El Dorado Estates are lined with a network of transit routes spreading out in every direction. Union Station and downtown Toronto are under an hour away, and every corner of the GTA is within reach.

1

Gage Park

A historic, multi-functional park providing recreational opportunities and events all year long.

2

Bramalea City Centre

One of Canada's largest malls with over 1.5 million square feet of retail space and more than 300 stores.



3

Eldorado Park & Playground

*Five picnic areas, two playgrounds,
Credit River and Brampton’s only
outdoor pool.*

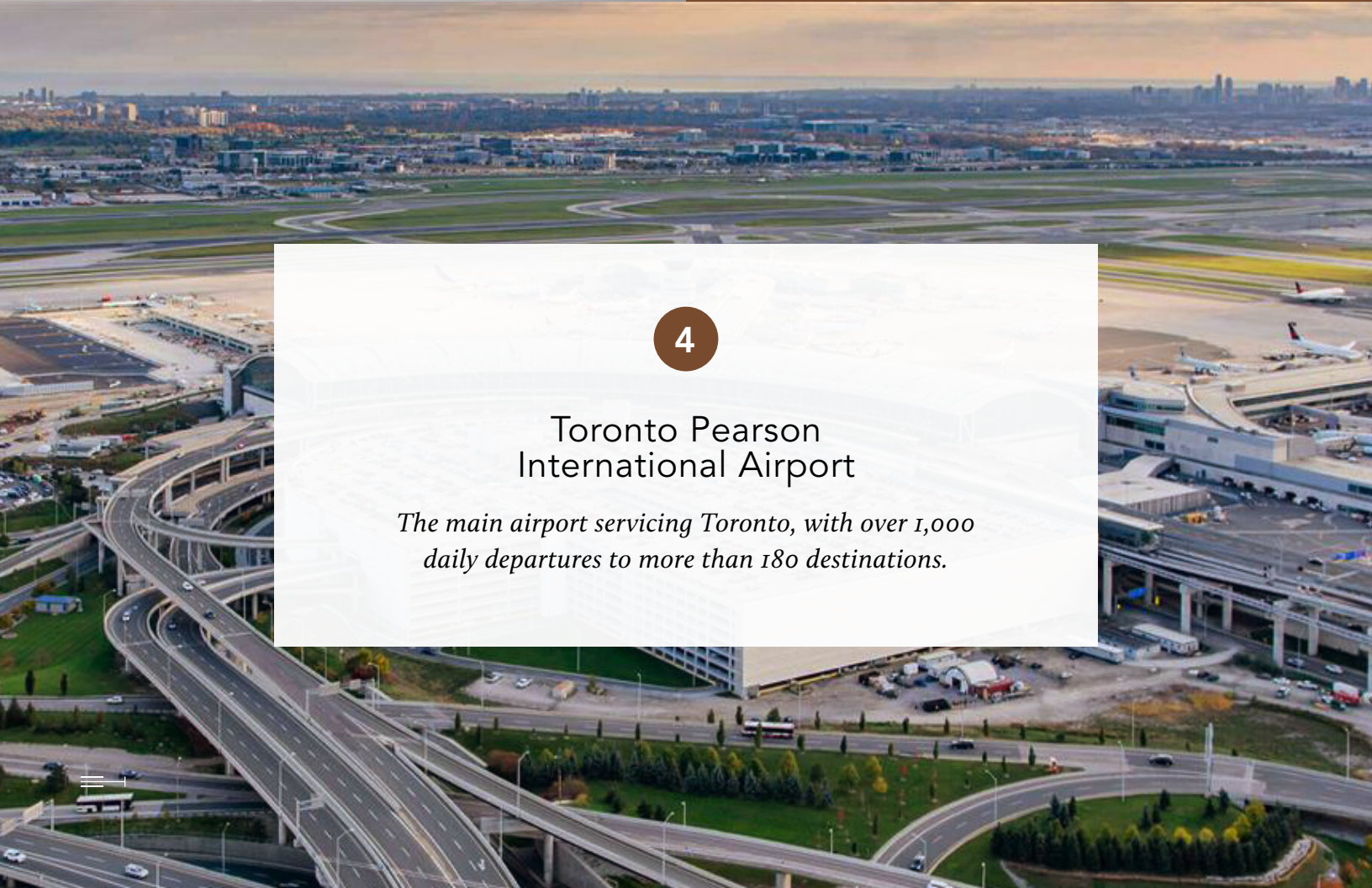

4

Toronto Pearson
International Airport

*The main airport servicing Toronto, with over 1,000
daily departures to more than 180 destinations.*

5

Highways 401 & 403

*Connect to Toronto, Mississauga and other hubs
across the GTA.*

6

Peel Village

*Affluent, established community of professionals
and growing families.*

7

Lionhead Golf Club & Conference Centre

*One of Ontario’s finest golfing experiences carved
into 520 acres of inspired natural terrain.*

8

Bradlee Ryall Golf Academy

*The award-winning, celebrated leader in golf lessons,
Junior Development and private golf coaching.*

TAKE A WALK
ON THE
WILD SIDE

Hike Sled Fish Skate Picnic Swim

From intimate pockets to vast swathes of parkland, El Dorado Estates places you at the centre of a lush, changing landscape. Leave the big city behind for a while, reconnect with nature, and enjoy a plethora of outdoor activities that you can share with the entire family.



Eldorado Park & Playground
8520 Creditview Rd

Gage Park
45 Main Street S

Joyce Archdekin Park
Main Street S





Golf

GET INTO
THE SWING OF
THINGS

*Award-Winning Championship
Facilities Coaching Community*

Whether you're an advanced golfer or just placing your first tee on the fairway, Brampton offers you some of the GTA's finest golf courses to hone your skills and perfect your swing.

Play on manicured lawns designed to win awards and surrounded by breathtaking scenery.

Lionhead Golf Club & Conference Centre
8525 Mississauga Rd

Bradlee Ryall Golf Academy
8525 Mississauga Rd

Royal Ontario Golf Club
6378 Trafalgar Rd, Milton

Entertainment

WITNESS THE SHOW GOES ON

*Art Exhibitions Collections Plays
Concerts Performances*

From local stores to global retailers, up-and-coming artists to sell-out shows, Brampton is a constant parade of energy and entertainment, inviting the city's residents into an environment where they see and are seen, where they're the centre of attention and part of something much, much bigger.

Bramalea City Centre
25 Peel Centre Dr,

The Rose Brampton
1 Theatre Ln

Peel Art Gallery, Museum and Archives
9 Wellington St E.





Flavours

SAVOUR THE GTA'S KITCHEN

*Bold Spicy Sweet Tangy Rich Creamy
Earthy Floral Fragrant Fruity*

Relish flavours from around the world, savour the work of experimental techniques and combinations, indulge in an alchemy of aromas and new spices: Brampton's rich multiculturalism is shown in its range of restaurants. Experiencing the GTA's kitchen is a sight for the senses.

Anokhi – Inspired Indian Dining
200 County Ct Blvd

Blackstone Steakhouse and Grill
31 George St N

Vesuvio Ristorante
91 George St S

School

TURN PASSION INTO PROFESSION

*Preschool Elementary
Middle High College*

The luxury of being close to many of the city's most established neighbourhoods is that trusted institutions are close too. There's learning for every age, from Montessori and kindergarten all the way through to secondary and post-secondary education.

Churchville Public School

90 Bonnie Braes Dr

David Suzuki Secondary School

45 Daviselm Drive

Sheridan College – Davis Campus

7899 McLaughlin Rd



STAY
CONNECTED
FAR AND
WIDE.

The Brampton Bond

GO, Züm, thoroughfares, highways: the streets around El Dorado Estates are lined with a network of transit routes spreading out in every direction. Union Station and downtown Toronto are under an hour away, and every corner of the GTA is within reach.



Brampton Innovation District
GO Station

10 minutes

Mount Pleasant
GO Station

11 minutes



James Potter –
Züm Queen West
Station Stop

3 minutes



Highways 407

10 minutes



Toronto Pearson
International Airport

23 minutes

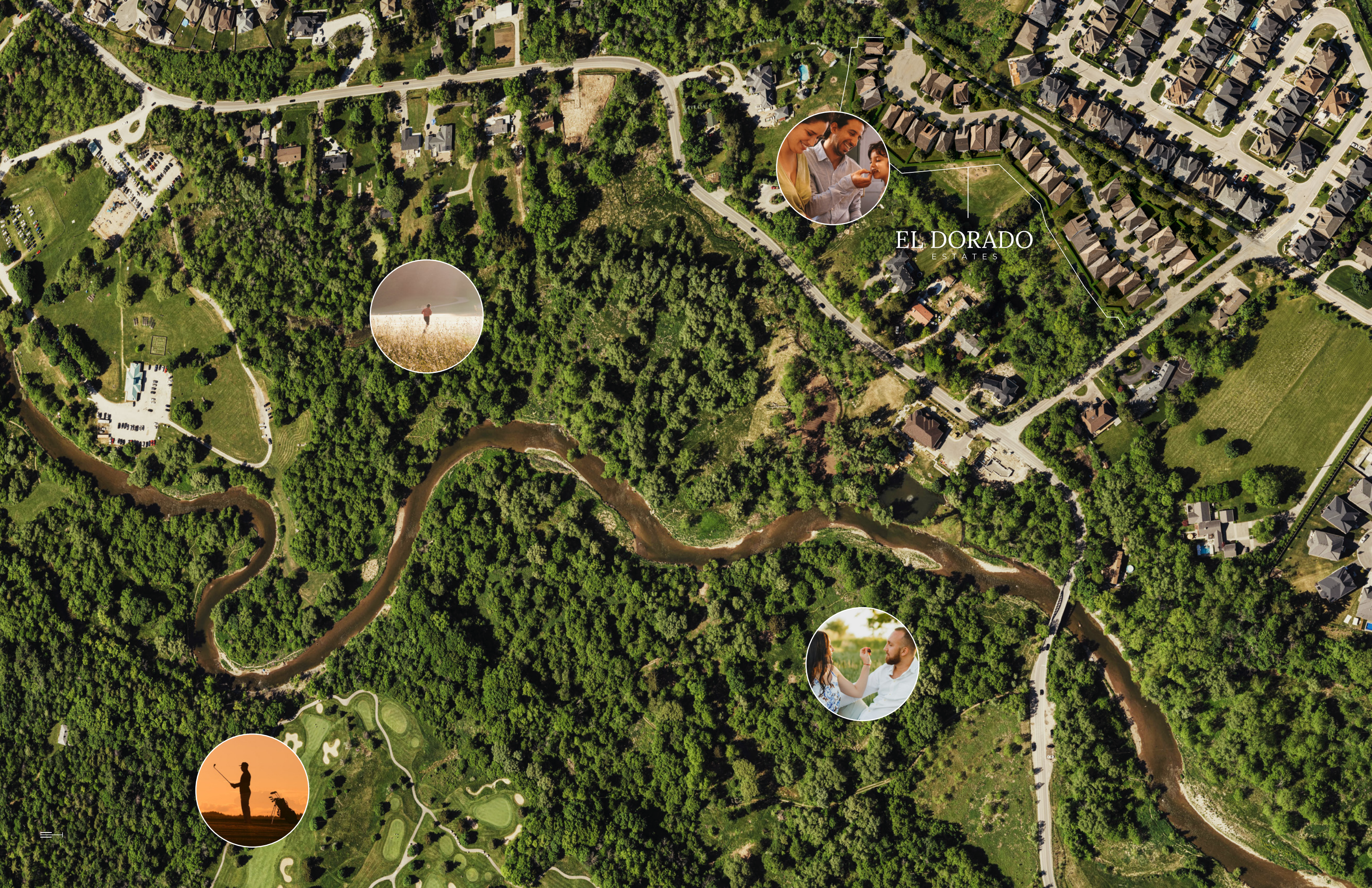

EL DORADO
ESTATES



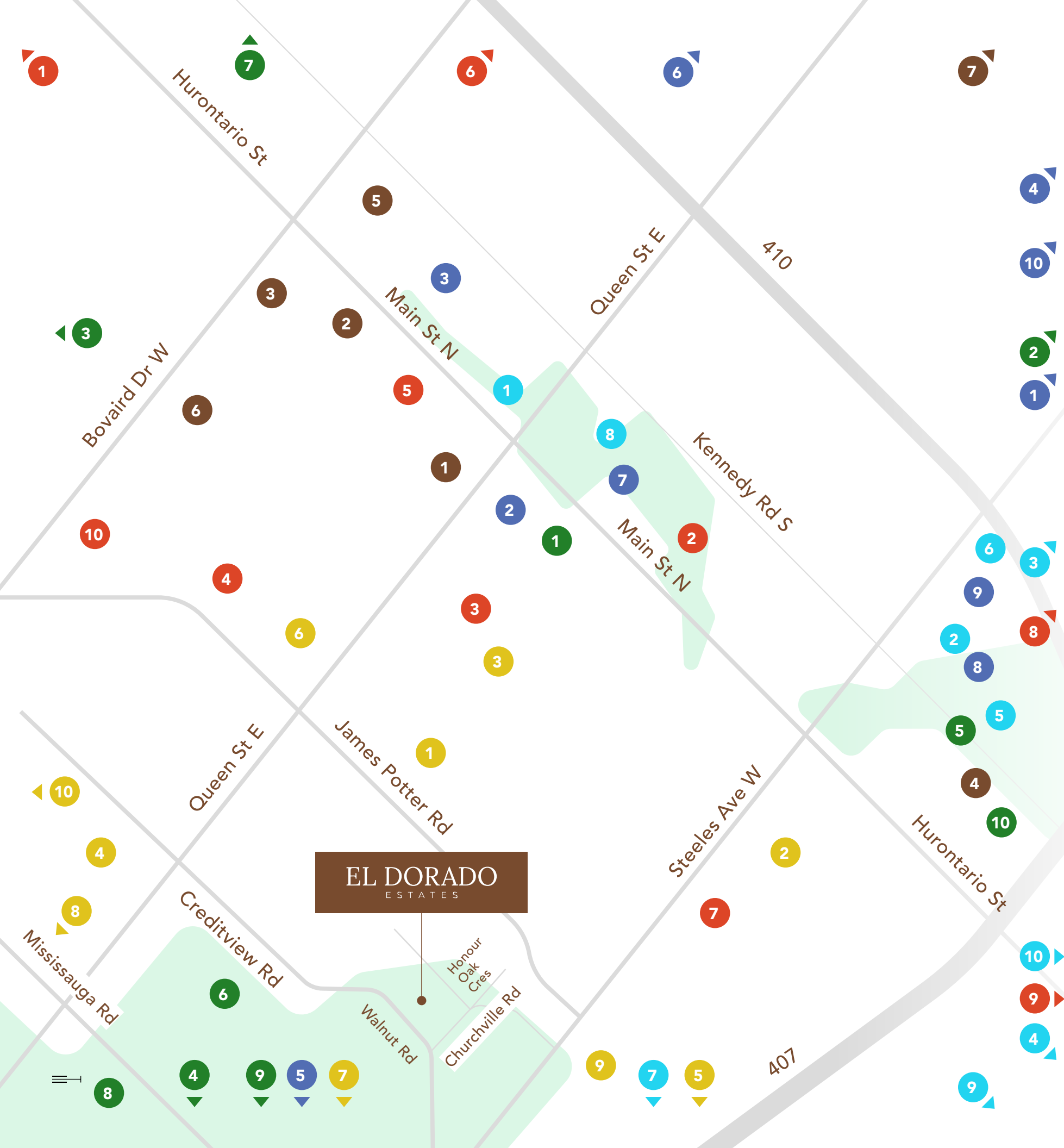

THE STREETS AND THE STORIES

Restaurants and Bars

- 1. La Capannina Restaurant
- 2. Osso Bucco Ristorante
- 3. The Keg Steakhouse + Bar
- 4. Mayura Indian Cuisinev
- 5. Tu Casa Fine Dining
- 6. Pho Peter Restaurant
- 7. Symposium Cafe Restaurant & Lounge

Shopping

- 1. Bramalea City Centre
- 2. Shoppers World Brampton
- 3. SmartCentres Brampton (Kingspoint Plaza)
- 4. Bramrose Square
- 5. Meadowvale North Shopping Centre
- 6. Trinity Common Mall
- 7. Brampton Mall
- 8. Brampton Corners Shopping Centre
- 9. Orion Business Park
- 10. Smart Centres Brampton

Entertainment

- 1. Rose Theatre Brampton
- 2. Playdium
- 3. Wild Water Kingdom (PAMA)
- 4. The Rec Room
- 5. CAA Centre
- 6. Cineplex Cinemas Orion Gate
- 7. Sky Zone Trampoline Park
- 8. Peel Art Gallery, Museum and Archives
- 9. Mississauga Celebration Square
- 10. Laser Quest

Groceries

- 1. Fortinos
- 2. Metro
- 3. Sobeys
- 4. Walmart Supercentre
- 5. No Frills
- 6. FreshCo
- 7. Real Canadian Superstore
- 8. Food Basics
- 9. Costco Wholesale
- 10. Asian Food Centre

Parks & Golf

- 1. Gage Park
- 2. Chinguacousy Park
- 3. Mount Pleasant Village Square
- 4. Royal Ontario Golf Club
- 5. Peel Village Golf Course
- 6. Eldorado Park
- 7. Heart Lake Conservation Area
- 8. Lionhead Golf Club & Conference Centre
- 9. Streetsville Glen Golf Club
- 10. Brampton Golf Course

Schools

- 1. Churchville Public School
- 2. Sheridan College – Davis Campus
- 3. St. Monica Elementary School
- 4. St. Jacinta Marto Catholic Elementary School
- 5. Levi Creek Public School
- 6. David Suzuki Secondary School
- 7. Eldorado Public School
- 8. Whaleys Corners Public School
- 9. Roberto Bondar Public School
- 10. Huttonville Public School



The Homes

LIVE BEYOND LUXURY

*Premium Homes in Nature.
A Very Limited Collection.*

The residences of El Dorado Estates were informed by beauty principles. An extraordinary amount of thought and time went into selecting the architectural styles, the modes of interior design and the materials. And it was entirely worth it.

The collection of homes stands as a moving still life, a portrait and interplay of forms, colours and textures that bring the façade to life in new and novel ways. Set back in some places and projecting out in others, the exterior walls feel almost fluid, windows have been carved at precise points and the interiors have been oriented according to their geography, all so that each home receives the most sunlight and the best views.

Premium features, such as 2-car garages, are common at El Dorado Estates. These residences have moved beyond conventional luxury to reach the rarified heights of subtlety, proportion, angles, accents and filigree.



The Builder

INTRODUCING
ESSENCE
HOMES

Essence Homes is one of the fastest-growing luxury real estate developers in Ontario. More than build homes, we create places in which to live and love, to grow and to be with family. Because above and beyond our pillars and, yes, underneath our roots, the essence of what we do and why we do it, is you.

To Innovation

We push the limits of technology and contemporary thought to instill the everyday with the state-of-the-art.

To Luxury

We curate the finest features and finishes into every space, so our residences are textured, storied and distinct.

To Design

We break the mold, disrupt the traditional and usher in a never-before-seen perspective on what a home should be.

For Family

Where the foundations are already in place, and you have the chance to start new and find yourself at the centre of everything to come.

For Community

Where the neighbourhood opens to gathering places and public spaces, communal experiences, shared lifestyles and personal milestones.

For Ownership

Where there is pride in ownership. It is not a sense or a feeling, but a knowing, that you belong here, and everything is yours.



*Essence Homes
has been years in the making, decades perhaps, because we became
who we are the moment you decided you were looking for us.*

EL DORADO

E S T A T E S



ESSENCE HOMES